



**WP外接线插座系列**  
**WP PUSH TERMINAL SERIES**

**Wp系列外接线插座主要技术指标 Specification of WP Push Terminal**

使用温度范围 Temperature	-40~55℃	耐压 Withstand Voltage	AC 500V(50Hz)/min
额定负荷 Rated Load	AC 50V 3A	线保持力 Keep Wire Force	1Kgf
接触电阻 Contact Resistance	≤0.03Ω	适用线材 Wire Range	AWG#24-#16
绝缘电阻 Insulation Resistance	≥100MΩ DC500V	寿命 Life	5000次

**WP2-2B**

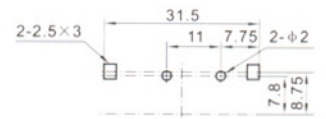
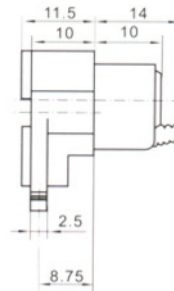
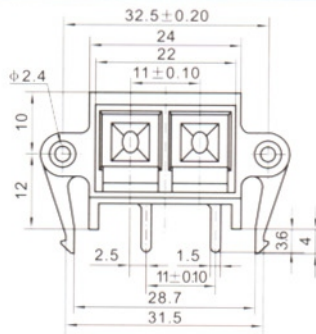
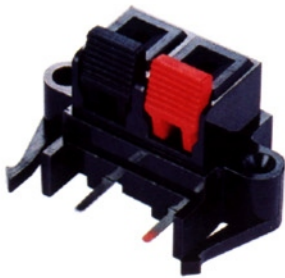

**WP2-6**

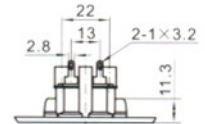
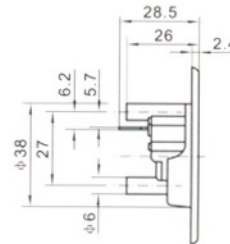
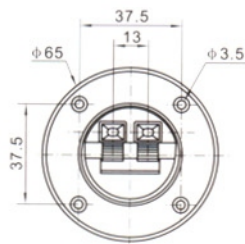

**WP2-8**

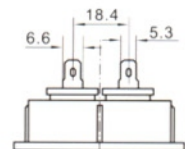
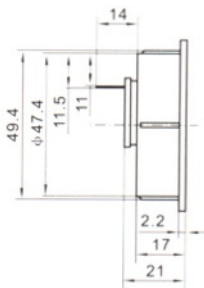
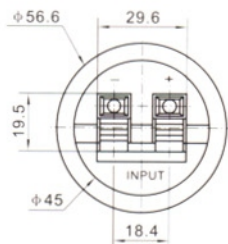

**WP4-2B**

